

East Perth Station upgrade

Project Update #4
August 2017

East Perth Station starts to take shape with overpass install



Over the last couple of months the upgraded station has started to take shape with the installation of the new overpass.

The overpass modules were delivered to site as two steel shells in June. Before being safely lifted into place, they were fitted out with roof sheeting, gutters, downpipes, electrical and communications conduits as well as the aluminium box fins that sit on the outside of the concourse. These fins were included in the design to tie in with the architectural elements of the neighbouring Public Transport Centre building.

You can check out a time lapse video of the overpass installation, along with progress shots of the station upgrade, at www.pta.wa.gov.au/eastperth.

Since the overpass has been installed, the concrete deck has been poured inside and the mesh screens fitted in place. Over the next few weeks tiles will be laid and the ceiling, handrails, lighting, speakers and CCTV will go in.

While the station's upgrade is on track to be completed in time for the opening of Perth Stadium next year, the new overpass will open and provide access to the platform by the end of September, this year.



The station's overpass was safely craned into place in two sections



Once complete, the \$25 million upgrade will make the station more modern, accessible and better able to host the larger crowds expected once Perth Stadium opens early next year.



Installation of concourse roofing



The concrete deck has been poured in the concourse



Internal fit out of concourse



Works update

In addition to the installation of the station's new overpass, the steel lift cores have been built and signalling and overhead line equipment work has been ongoing.

This illustration shows the completed work to date in green which includes Stage 1 concrete foundations, platform walls, station overpass and lift steel work. The yellow sections are works to be completed in the coming month including Stage 1 canopies, lift glazing and cladding, concourse cladding, precast stairs and platform paving. Stage 2 of the station upgrade is represented in grey and will start in late September.

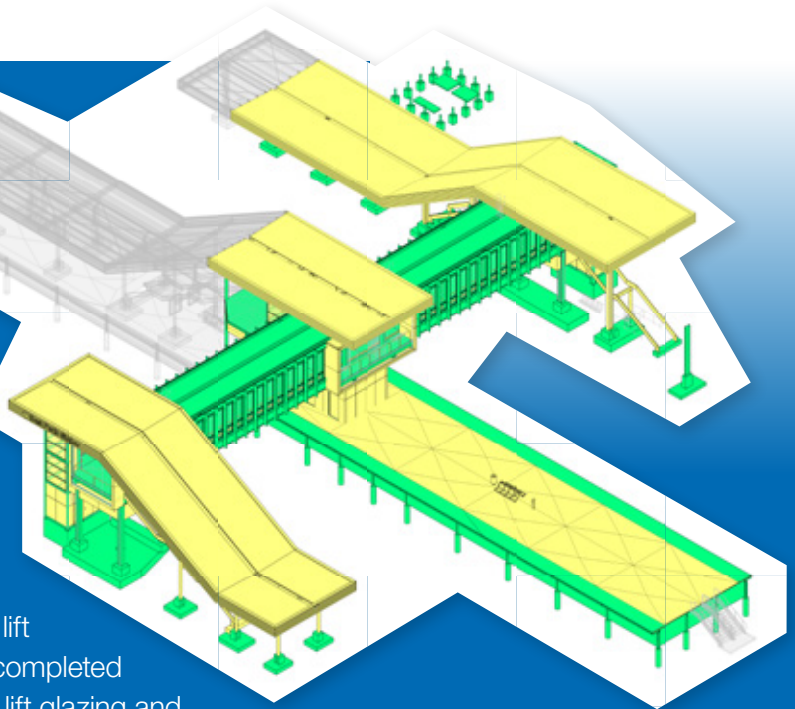

! Platform gap change

On 20 August, a 52m section of the new platform – at the northern end of the station – will open. As such, there will be a temporary change to the platform gap causing the train to sit lower than the platform.

When boarding the train, passengers will need to step **down** into the train. When leaving the train, passengers will need to step **up** onto the platform. The best position to board the train will be from the temporary platform at the northern end of the station. If you would like special assistance at the station, please call 1800 800 022 at least an hour before you travel. Once the new tracks are installed at the end of September, the train will sit level with the platform.

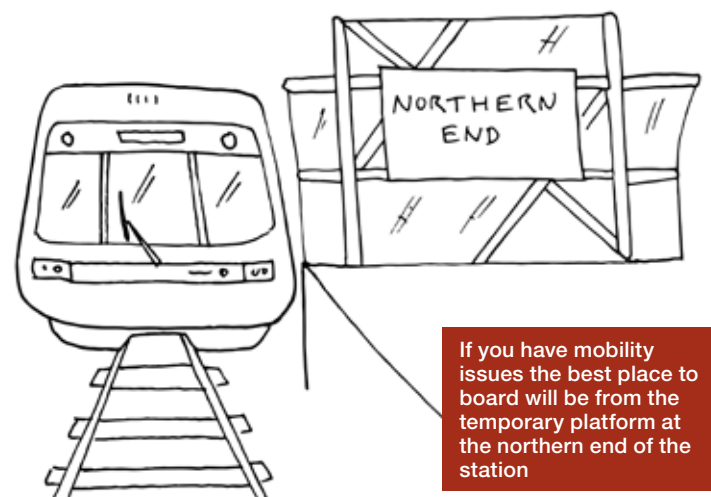

Out-of-hours works

To continue work on the East Perth Station upgrade, the following out-of-hours work is required:

Date	Task and location
Monday 14 August, 9pm to Tuesday 15 August, 5am	<ul style="list-style-type: none">• Delivery of rail into East Parade car park;
Friday 18 August, 7pm to Sunday 20 August, 7am	<ul style="list-style-type: none">• Remove the existing temporary platform at southern end of the station and open the new platform;
Sunday 20 August to Thursday 24 August, between 10pm and 5am each day	<ul style="list-style-type: none">• Undertake bulk excavation to south of station;• Demolish part of the existing platform and install new platform walls;
Friday 1 September, 8pm to Monday 4 September, 5am	<ul style="list-style-type: none">• Install platform canopy roof; and• Install overhead line equipment masts and undertake rewiring and signalling works.

This work is required to take place out of hours to reduce disruption to Midland Line services and ensure the safety of our passengers and the general public.



All work will follow an approved Noise Management Plan, however some noise and disturbance is unavoidable. Monitors will be set up in various locations within the construction area to monitor noise levels. We apologise for these disruptions and any inconvenience they may cause.

Standard construction hours are 7am to 7pm, Monday to Saturday. During out-of-hours works, if you feel there is excessive noise please contact the **Site Supervisor directly on 0428 358 569**. This allows them to immediately review the source of the noise and if possible, put mitigation measures in place. Alternatively, for daytime feedback and other enquiries about the project, please contact the Perth Stadium project team on **9428 1961** or visit **perthstadium.com.au** or **www.pta.wa.gov.au/eastperth**.



Virtual Reality App

Check out what the station will look like once the upgrade is complete through the EPSU virtual reality app. There's also progress photos of the build as well as time lapse vision and interviews with various members of the design and construction team. Haven't got the app yet? You can download it from the Google Play or App Store.



MORE INFORMATION

For more details about the upgrade, including information on impacts for passengers, local residents and cyclists, please see the East Perth Station upgrade **project page** at www.pta.wa.gov.au

Stay informed of the project's progress by **registering for email updates** at www.pta.wa.gov.au under the Projects tab. Please direct queries regarding this project to 9428 1961 or projects@pta.wa.gov.au

More information on Perth Stadium and transport options to the new venue can be found at perthstadium.com.au